

StarHub Fibre Broadband Installation

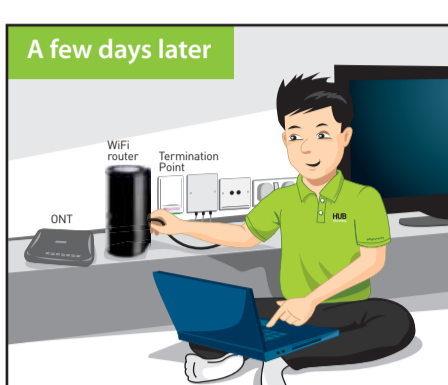

Getting your Fibre Broadband installed

- 1 Termination Point installation**
Installation by OpenNet contractors in the living room (preferably near the TV).
- 2 Preparation for fibre broadband installation**
2 unused power points will be needed: 1 for the Optical Network Terminal (ONT) and 1 for the WiFi router.
- 3 ONT and network router installation**
Installation by Hub Troopers to complete fibre broadband set-up. A wireless assessment will be conducted at 2 locations in your home.

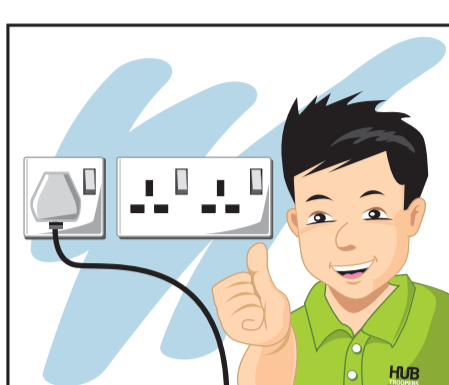
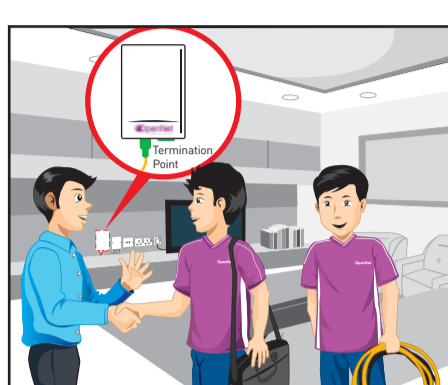

Click [here](#) for more information on Fibre Termination Point installation

Typical Fibre Broadband Home Set-Up

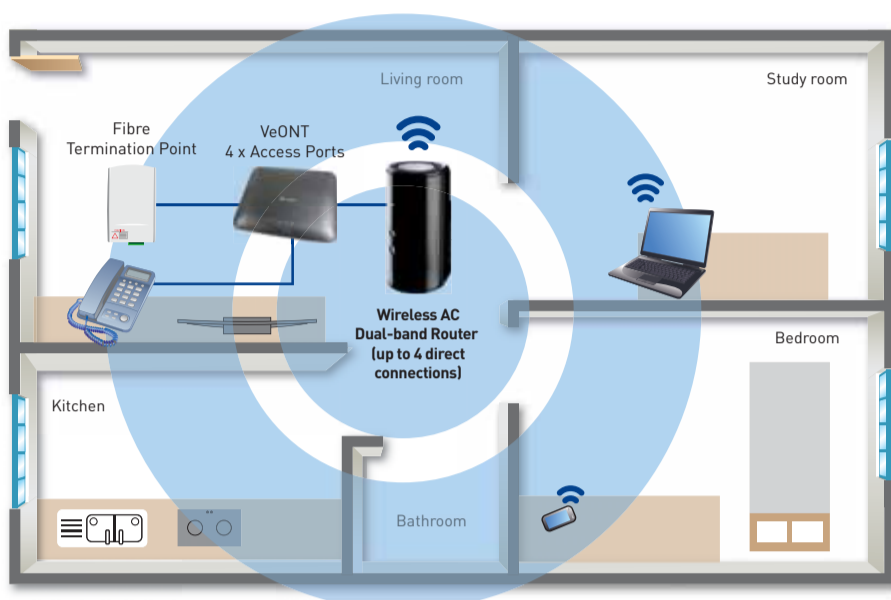

Ways to boost your home WiFi coverage:

- 1 2 superfast broadband connections to ensure supersize WiFi coverage at home** Recommended

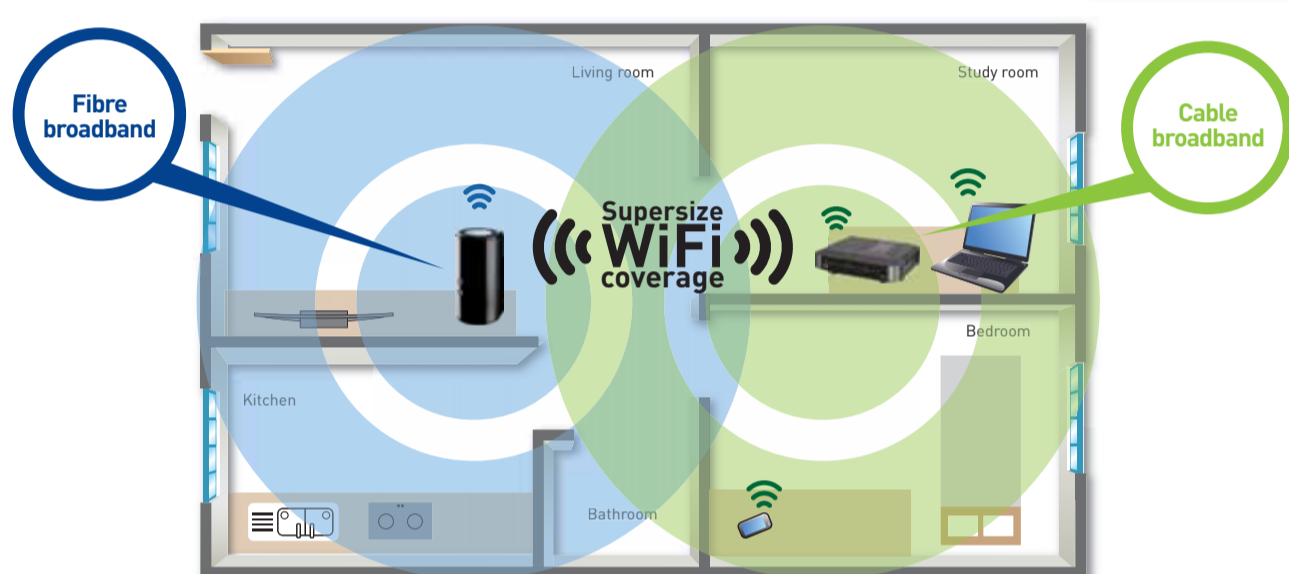

- 2 Use a WiFi Extender to bring WiFi signals into all parts of your home.**

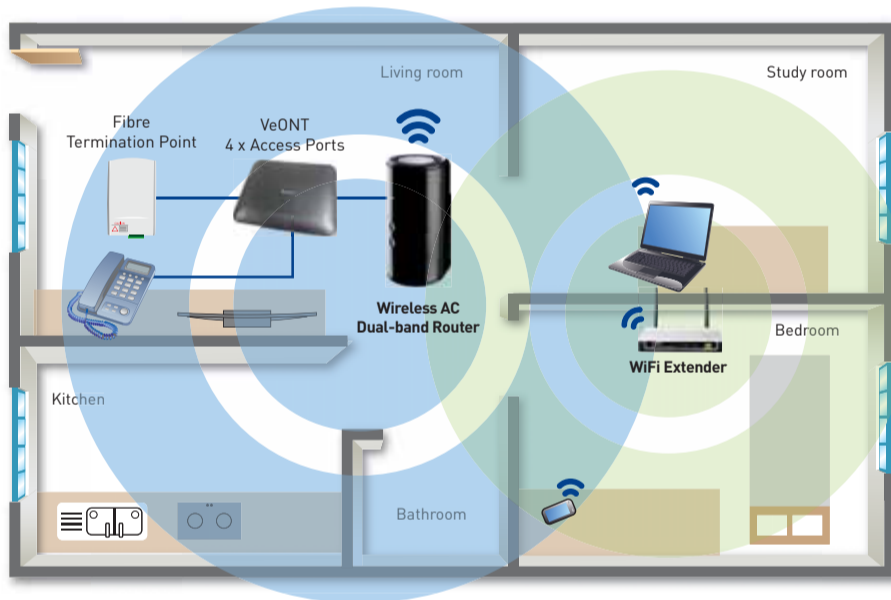

- 3 Use Data Points to get wired connection in different areas of your home. Data Point cables will be concealed with surface trunking.**

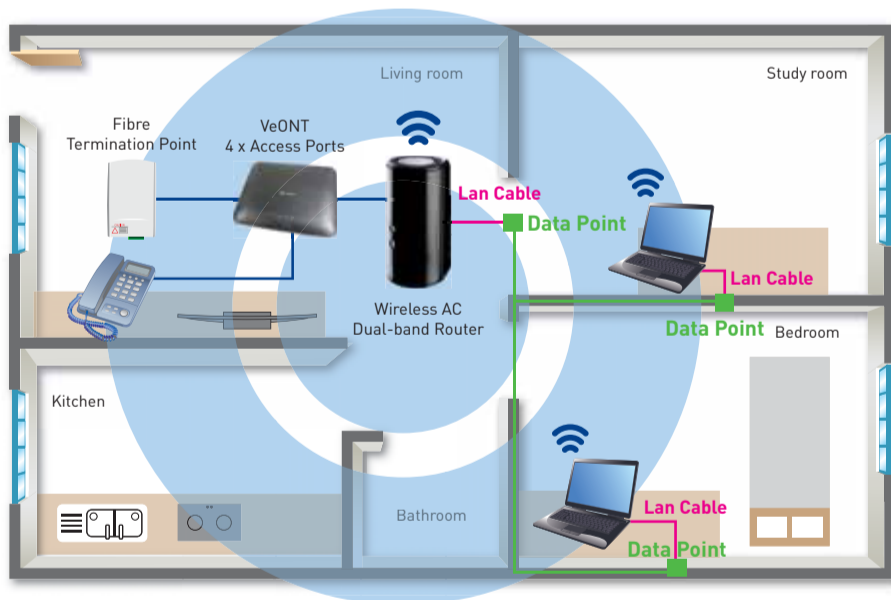

StarHub WiFinder

You can now use your smart phone to analyze and optimise the wireless connection in your house:

- Locate WiFi channels around you and the one that is least crowded.
- Suitable for non-tech savvy users with simple guided step-by-step analysis and recommendations.

Download the app now!

Wireless Limitations

Factors affecting wireless network connection:

Obstacles

Number of walls, walls density and distance affect wireless signals.

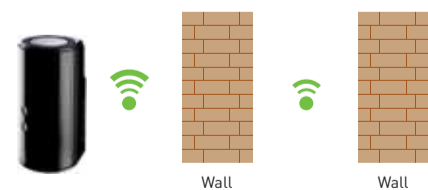

Signal interference

Other routers and home appliances interfere with the wireless bandwidth.



Other Service Charges

Service activation fee/ SIM card charge	\$32.10
Installation fee (per computer connection)	\$53.50
Installation of 3rd party device (per device connection)	\$53.50
Delivery fee (per trip to the same service address)	\$53.50
Service call (per computer connection)	\$53.50
Service early termination charge (if subscription is less than 3 or 12 months)	\$385.20

Optical Fibre Termination Point installation (High Rise - Condo or HDB)	\$235.40
Optical Fibre Termination Point installation (Landed)	\$481.50
Fibre service cancellation charge (applies after appointment date has been scheduled)	\$235.40 (high rise) \$481.50 (landed)
Additional fibre cable after initial 15m from fibre entry point	\$35.31 (per 5m)
Relocation Fees	
Relocation of service address	\$107.00
Activation	\$32.10
Installation	\$53.50